



V-TUF RAPID HB240-21 HOT BOX

Product Code: RAPIDHB240-21



English
Operators
Manual



CE

© V-TUF

GLOSSARY

In the present list they are rechon up the terminologies and abbreviation descriptions most commonly used on the present manual.

H.P.	High pressure	Rif.	Reference
L.P.	Low pressure	V	Volt
min.	Minimum	Ah	Ampere
max.	Maximum	Hz	Hertz
1'	Minutes	kW	Kilowatt
h	hour	°C	Degrees centigrade
H	Heigh	kg	Kilogram
L	Lenght	CO	Carbon dioxide
Fig.	Figure	l/h	Litres/hour
Pag.	Page	Mono	Monophase
Sez.	Section	Tri	Triphase
Automat.	Automatically	TS	Total Stop
Man.	Manual	CEE	European Economic Community

LEGENDA

FLUXOSTATH Device suitable for take off the flux of a liquid

SUMMARY

1	INTRODUCTION	Pag. 1	14	WRONG USE	Pag. 8
2	GENERAL DIRECTIONS	Pag. 1	15	PRECAUTIONS	Pag. 10
3	IMPORTANT RECOMMENDATIONS	Pag. 2	16	INSTALLATION	Pag. 11
4	TECHNICAL FEATURES	Pag. 3	17	USE	Pag. 11
5	TECHNICAL DATAS	Pag. 4	18	MAINTENANCE	Pag. 13
6	DIMENSIONS	Pag. 5	19	FAULT - CAUSE - REMEDIES	Pag. 15
7	MACHINE DESCRIPTION	Pag. 5	20	SYSTEM PLANS	Pag. 16
8	IDENTIFICATION DATA	Pag. 6	21	TRANSPORT - HOISTING - DISPLACEMENT	Pag. 17
9	CONTROLS	Pag. 7	22	STORING	Pag. 17
10	ADHESIVES	Pag. 7	23	WARRANTY CONDITIONS	Pag. 18
11	OUTFIT	Pag. 7	24	ACCESSORIES	Pag. 19
12	SAFETY STANDARDS	Pag. 8	25	SCRAPPING	Pag. 20
13	IMPROPER USE	Pag. 8			

TECHNICAL FEATURES

Fire proof feeding cable.

Fiber-glass reinforced incoming sheathing cable.

Equipotential circuit.

Plastic switchboard.

Painted steel frame.

Cover in plastic material fixed by means of screw.

Noise level below the limits according to the directives.

Boiler V1 type with double steel coil at high thermal conductivity, upper, lower head and vane in stainless steel, bottom made of thick refractory cement, embedded in the casing .

Quick coupling assembled on the water inlet and outlet.

Two rigid type rubber wheels.

Two pivotant type rubber wheel (one with parking brake).

High tension transformer.

Safety valve.

No return valve.

Fluxostath.

Termostath.

Painted steel gasoil tank.

The machine is constructed with riciclables materials.

The mobile boiler can work in joining with every cold water high pressure washer to obtain warm water.

TECHNICAL DATAS

MODEL	200
MAX. PRESSURE	200 bar
MAX POWER	450 W
MAX. FLOW	900 l/h
MAX. WATER FEEDING PRESS.	4 bar
WATER TEMPERATURE	30/150 °C
THERMAL POWER	53.000 K cal./h
POWER SUPPLY	230 V monophase
WEIGHT	70 kg
GASOIL TANK CAPACITY	11 litres
EXHAUST SMOKE	less than 2 on the "Shell Bacharach" scale
CO RELEASE	less than 0,04% of the volume
FREQUENCY	50 Hz

60 Hz version, upon request

MAX BEARING VALUES OF THE ACOUSTIC LEVELS

ACOUSTIC PRESSURE LEVEL IN ATMOSPHERE

ACOUSTIC POWER LEVEL

LEVEL OF THE ACOUSTIC PRESSURE AT THE OPERATING PLACE

Less than the limits
according to the
EEC directives



MACHINE DESCRIPTION

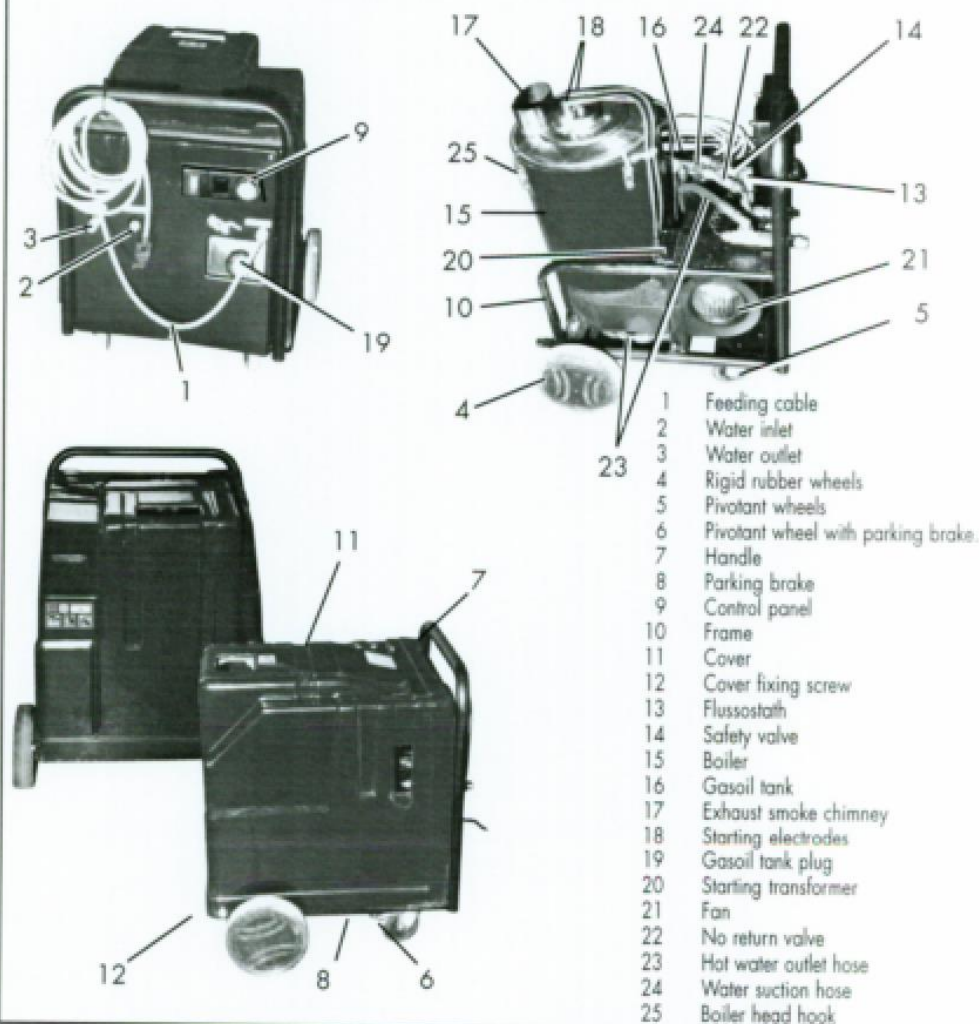

CONTROLS



- 1 ON/OFF switch
- 2 Thermostat adjusting knob

PRECAUTIONS

Before starting the machine, make sure that the inlet water supply is properly connected (1 bar min., 4 bar max.), running dry, can damage the pump.

Always check that the exhaust smoke chimney and the air intakes are not obstructed.

As a safety measure for the worker and for the machine same, do not modify the H.P. washer without the manufacturer permit in writing.

If You detect find a damage, before starting a working, immediately contact Your Dealer.

When using the H.P. cleaner , never cover it; however if You think that is necessary to protect it, do it letting the air through so as to cool down the motor.

Switch the machine off, during longer idle periods (more than 15/20 minutes), and unload the pressure in the machine by pulling the spraying gun trigger.

For working breaks of one hour or more , it is necessary to remove the electrical plug from the electrical socket.

The maintenance works, requires the intervention of semi-skilled personnel that are also acquainted with this instructions manual and all the same well-informed about the safety general regulations as about the machine's specific safety systems.

For repair, special maintenance operations or for the setting up of the machine, apply to the Customer Service Centre or to the authorized technicians only.

INSTALLATION

OPERATORS IN CHARGE

The machine installation will be carry out only by skilled technicians with the care and responsibility of the user.

Connect the suction hose to the inlet coupling.
Connect the outlet hose to the outlet coupling.
Connect the other end of the suction hose to the water tap.

Check that the electric plug has all the required characteristics and the proper differential protection than, connect it into the electrical socket.

NOTE: if is possible, do not use electrical extensions.

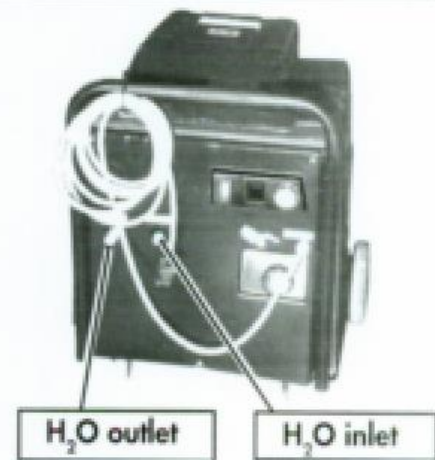
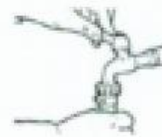

WARNING: the electrical feeding network must be equipped with an high sensibility differential switch with an interference thresold id equal to 30 mA.

The machine must be earthed at a contact voltage resistant value not over 25 V.

The machine must be installed so that the pipings cannot be damaged by people or things.
The machine should be placed out of passage ways and in order to avoid mechanical stress and damages.

USE

CHECKS BEFORE USE

Before the use, check that all the parts was fitted up and that the installation was checked by skilled personnel.

Check that are gasoil in the apposite tank, if not, fill up.

Turn on the water tap.

Check that the thermostat is in "0" °C position.

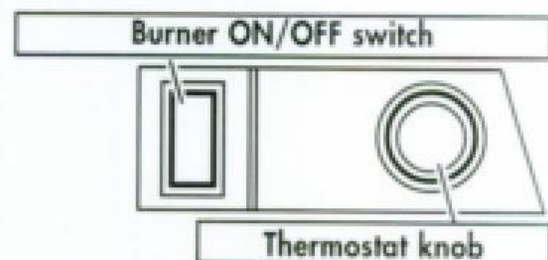

Start the machine acting on the apposite (ON/OFF) burner switch and wait for 30 sec. fto obtain the filling of the gasoil pump, act on the thermostat knob and put the temperature selector at 90° C for almost 30 sec. than, select tha water working temperature acting on the same knob.

When the request temperature is reached, the burner automatically stop and start again every time the temperature reachees.

At the end of the work, put the thermostat knob at ("0") 0° C position and wait for the water to be cold.

Act on the (ON/OFF) burner switch to stop the machine then, close the water tap.

USE

USE IN ENCLOSED AREAS

In case the machine is placed in an enclosed area, You have to install the chimney adapter our code: 5000030. We suggest the use of a chimney as illustrated in the picture.



WARNING: the chimney (2) diameter (Z) should not be inferior than the adapter (1).

USE IN WINDY PLACE

In case the machine is placed in a windy place, You have to install the chimney adapter our code: 5000030. This precautionary measure can avoid damages to Your machine.

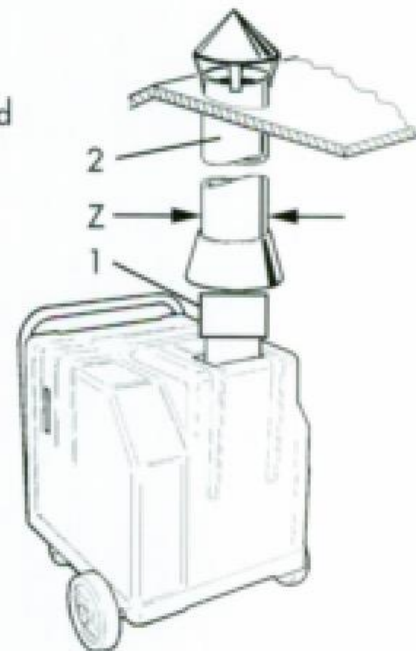
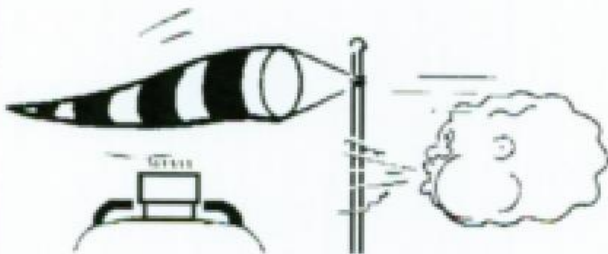

MAINTENANCE

Maintain in efficiency the equipment it means to ensure more reliability and a longer life; please follow simple check on a regular basis.



SAFETY RULES

Do not consent intervention on the machine at not authorized personnel.

Do not carry out any intervention without preventive authorization.

Before every check and/or maintenance work, check that the machine is not connected to the current net and to the hydraulic net.

Do not put the limbs into the openings of the machine parts without the aid of suitable guards.



Do not align the holes with the fingers but only using the suitable centering tools.

Never use gasoline, solvents or other flammable liquid to clean; instead apply to the commercialized detergents, authorized, unflammables and untotoxic.

Using compressed air for clean or dry parts of the machine, protect the eyes with goggles equipped with side guards and limit the air working pressure at max. 1,9 bar.



Every day keep clean and in good order the machine.

Immediately replace each notice, warning or instruction plate that is not readable or missing.



WARNING: a poorly adjustment of the burner, increases the fuel consumption and causes environmental pollution.

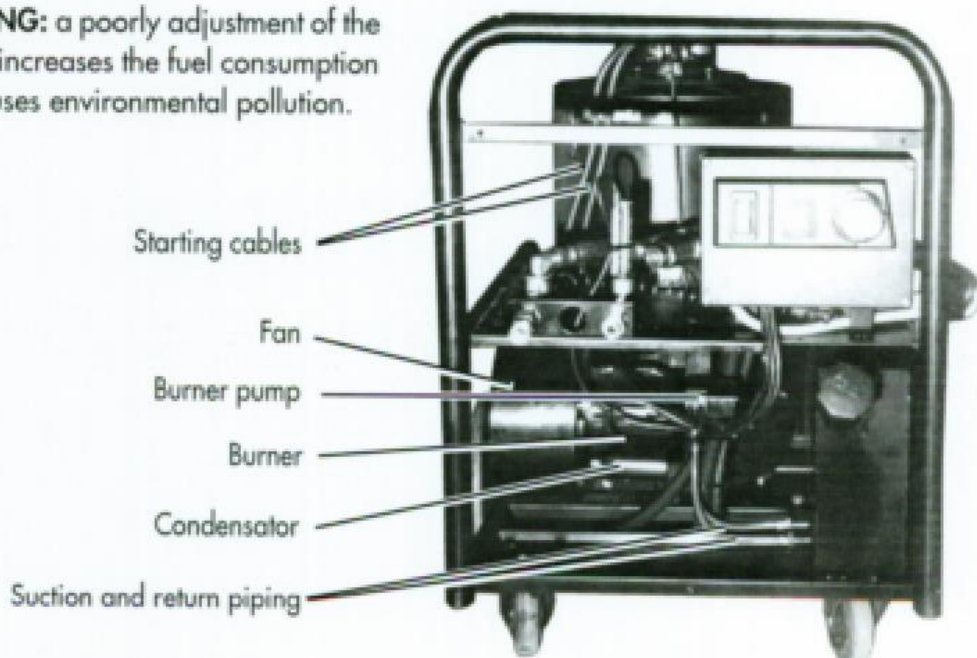

WARNING: if the machine remain for a long time idle, before using it for any cleaning operation, we suggest to let the water flow in the coil for some time, till it comes out clean.

BURNER MAINTENANCE

The burner installed on our high pressure cleaner, runs only with gasoil. Periodically check and clean the filters and the fuel nozzle, we recommend the replacement of the same every 400 working hours.

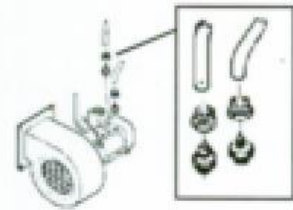

BODY AND TANK WORK MAINTENANCE

Wash the machine only with neutral surface-active products and water in order to eliminate corrosive agents (such as salt, sand, etc.); accurately dry so as to thoroughly eliminate any patches of water.

If trace of dirt persist, we recommend the use of specific products following the instructions provided by the manufacturer.



WARNING: DO NOT USE products containing aromatic solvents, methanol or hydrocarbon.

HYDRAULIC SYSTEM

Periodically check that all the system parts are correctly tight and that are not leakages.

COIL

If the coil is covered with sooth, You should check the burner at the Customer Service Centre.



AIR FLOW ADJUSTMENT

On 60 Hz models is installed an air flow adjusting blade; this device placed between the fan and the boiler is adjusted by the manufacturer but acting on the apposite nut, the slope will be changed for allow a small or a greater air flow.

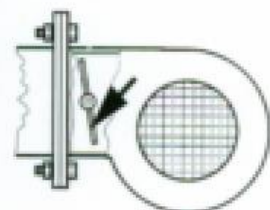

ELECTRODES SETTING

To obtain the best performances of the machine, check that the starting electrodes are always placed as shown in picture.

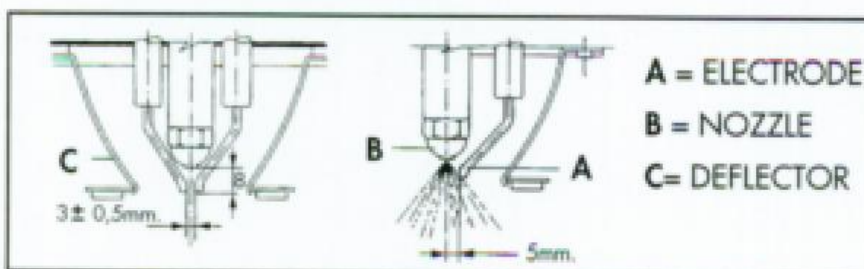

WARNING: for repair, special maintenance operations or for setting up of the machine, apply to the Customer Service Centre or to the authorized technicians only.

FAULT	CAUSE	REMEDY
The water does not reach working temperature.	Damaged thermostat. Thermostat adjusted too low. Scale in the hydraulic system. Sooted boiler.	Replace. Place the thermostat at the required temperature. Contact the Maintenance Service. Contact the maintenance Service.
The boiler is smoking.	Water in the gasoil tank. Incorrect gasoil pressure. Electrodes improperly positioned. Fuel nozzle dirty. Fuel nozzle worn out. Heating coil blocked by soot. Gasoil pump dirty. Gasoil solenoid valve not operating.	Completely drain the gasoil tank than, fill up with clean gasoil. Turn the adjusting screw until obtaining aprox. 10 bar; contact the Maintenance Service. Adjust the distance between the electrodes; contact the Maintenance Service. Clean the fuel nozzle. Replace the fuel nozzle. Clean the heating coil. Disassemble the pump and clean the filter; contact the Maintenance Service. Replace the solenoid valve.
The burner cut out during operation.	Gasoil tank empty. Water in the gasoil tank. Fluxostath damaged. Starting transformer damaged. Rotation of the starting electrodes. Gasoil nozzle dirty. Gasoil nozzle damaged. Gasoil pump damaged. Gasoil solenoid valve damaged.	Fil up the gasoil tank. Completely drain the gasoil tank and fill up with clean gasoil. Replace the fluxostath. Replace the transformer. Set the electrodes back to their proper position; contact the Maintenance Service. Clean the nozzle. Replace the nozzle. Replace the gasoil pump. Replace the gasoil solenoid valve.
The motor does not start.	No current.	Check if the plug is in the socket and if there is current in the network.

SYSTEM PLANS

WIRING DIAGRAM

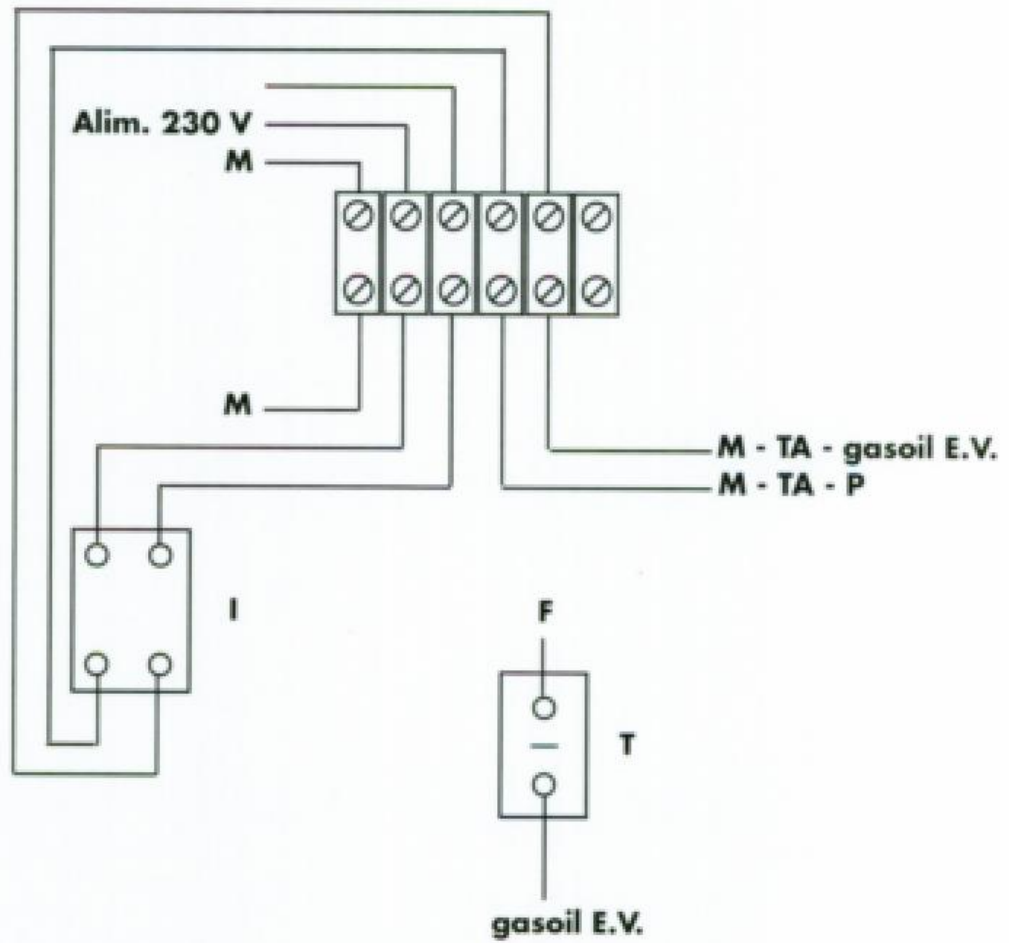

- I Switch
- MP Burner motor
- TA Transformator
- F Fluxostath
- E.V. Gasoil solenoid valve
- T Thermostat
- M Ground

V-TUF

Great Britain

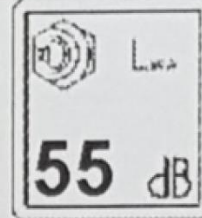

Model / Modello	MOBILE BOILER
Type / Tipo	V-TUF RAPID HB240-21
Serial Nr. / Numero di serie	058135
Lot production / Lotto	06/19
Working pressure	58-3625 psi
Pressione d'esercizio	4-250 bar
Feed press. Min. / Max.	58 / 145 psi
Press. di Aliment. Min. / Max	4 / 10 bar
Max feeding temp.	86 °F
Temp. Max Aliment.	30 °C
Water output max. temp.	284 °F
Temp. Max Uscita Acqua	140 °C
Motor horsepower/Potenza effett.	0,5 Kw
Numero di Giri/ R.P.M.	2800 Rpm
Frequency/Frequenza	50 Hz
Voltage / Tensione	230V 1~+T
Max pressure	3625 psi
Pressione Massima	250 bar
Delivery	5,55 Gpm
Portata	21 l/min.
Boiler Output/Potenza Caldaia	58 Kw/h

Our Company reserves the right to introduce at any time, eventual changes for technical or commercial reasons, therefore informations, descriptions and illustrations contained in this publication, are updated until their approval for the printing.

WARNING: the graphic illustration of the part, can be different from the detail mounted on the machine, only the code number on the spare parts catalogue, determinates the spare part validity.



For more details contact us:

UK Head Office:
+44 (0) 1522 797879

V-TÜF
Unit 5 Chris Sharp Building
Till Bridge Lane
Scampton
Lincoln
LN1 2SX
United Kingdom

E-mail: enquiries@v-tuf.com

Web: www.v-tuf.com

Follow us:

