



RECHARGEABLE 360° INSPECTION LAMP COB LED COLOUR MATCH CRI 96 - 3 COLOUR

MODEL NO: LED360CM.V4

Thank you for purchasing a Sealey product. Manufactured to a high standard, this product will, if used according to these instructions, and properly maintained, give you years of trouble free performance.

IMPORTANT: PLEASE READ THESE INSTRUCTIONS CAREFULLY. NOTE THE SAFE OPERATIONAL REQUIREMENTS, WARNINGS & CAUTIONS. USE THE PRODUCT CORRECTLY AND WITH CARE FOR THE PURPOSE FOR WHICH IT IS INTENDED. FAILURE TO DO SO MAY CAUSE DAMAGE AND/OR PERSONAL INJURY AND WILL INVALIDATE THE WARRANTY. KEEP THESE INSTRUCTIONS SAFE FOR FUTURE USE.



Refer to instructions

1. SAFETY

- ❑ **WARNING!** Inspect the cable and connector for wear and damage to ensure items are safe before connecting to the power supply. If worn or damaged **DO NOT** use.
IMPORTANT: Ensure the lamp is fully charged before initial use.
- × **DO NOT** charge in damp conditions.
- × **DO NOT** turn the lamp on when it is being charged.
- × **DO NOT** shine directly into your, another person's or an animal's eyes. **DO NOT** allow children to use the lamp.
- × **DO NOT** handle or move the lamp whilst it is being charged.
- × **DO NOT** use the lamp if you suspect that the battery or the lamp casing is damaged.
- × **DO NOT** leave battery in a discharged state, recharge battery immediately. Before storage, fully recharge the battery, subsequently recharge the battery at least once every six months of non-use.
- × **DO NOT** attempt to open, disassemble, modify or service the battery pack.
- × **DO NOT** crush, puncture, short external contacts or dispose of in fire or water.
- × **DO NOT** expose to temperatures above 60°C (140°).
- ✓ Replace only with the battery pack designated for this product.
- ✓ Recycle or dispose of used battery as stipulated by local regulation.
- ✓ If the electrolyte in the cells gets on your skin, thoroughly wash with soap and water. If it gets in your eyes, rinse thoroughly with cool water and seek immediate medical attention.

2. INTRODUCTION

Handheld rechargeable inspection lamp with a high Colour Rendering Index (CRI 96) suitable for accurate colour matching. The light produced by the COB LED is ideal for detecting swirls and differences in paint colour when touching up areas of bodywork. Single button features three colour options to choose from - 2700k, 4500k and 6500k producing 450 lumens. Fitted with a patented magnetic 360° swivel base and hanging hook for hands-free operation. Features a LED battery level indicator and light is powered by a high quality 3.7V 2.6Ah Li-ion battery. Supplied with micro USB lead.

3. SPECIFICATION

Model No: LED360CM.V4
 Battery: 3.7V 2600mAh Li-ion
 LED Quantity: 1 COB
 Lumen Output (High/Low): 450lm
 CRI Rating: 96
 Operating Time: 2hr
 Charging Time: 4hrs
 IP Rating: 65
 Nett Weight: 0.43kg

The battery fitted to this lamp is considered to be a consumable item and its ability to accept a charge will reduce over time. We will provide warranty against mechanical and electrical defect for a period of one year - this does not cover fair wear and tear. If the battery is not properly charged before first use, or regularly conditioned, its capacity will diminish. Under these circumstances we will not replace the battery regardless of whether the battery less than one year old.



4. OPERATION

- 4.1. Connect the USB lead to the socket on the rear of the lamp. Plug into USB power supply and turn on, the charging LED's on the lamp will flash green to show that charging has commenced.
- 4.2. The number of green lights flashing indicate the level of charge
- 4.3. When the battery has fully charged all the LED's will show steady green.
- 4.4. Direct the lens away from your eyes before switching on.
- 4.5. Toggle the lamp between light levels using the ON/OFF switch.
- 4.6. The lamp may be suspended by the hook or attached to any ferrous surface by using the magnet.
- 4.7. When the light is hanging from the hook it can be rotated through 360° for more precise positioning.
- 4.8. Separate the top and bottom sections by pulling apart. When attached to a ferrous surface, using the base magnet, the lamp can be rotated to shine in any direction.

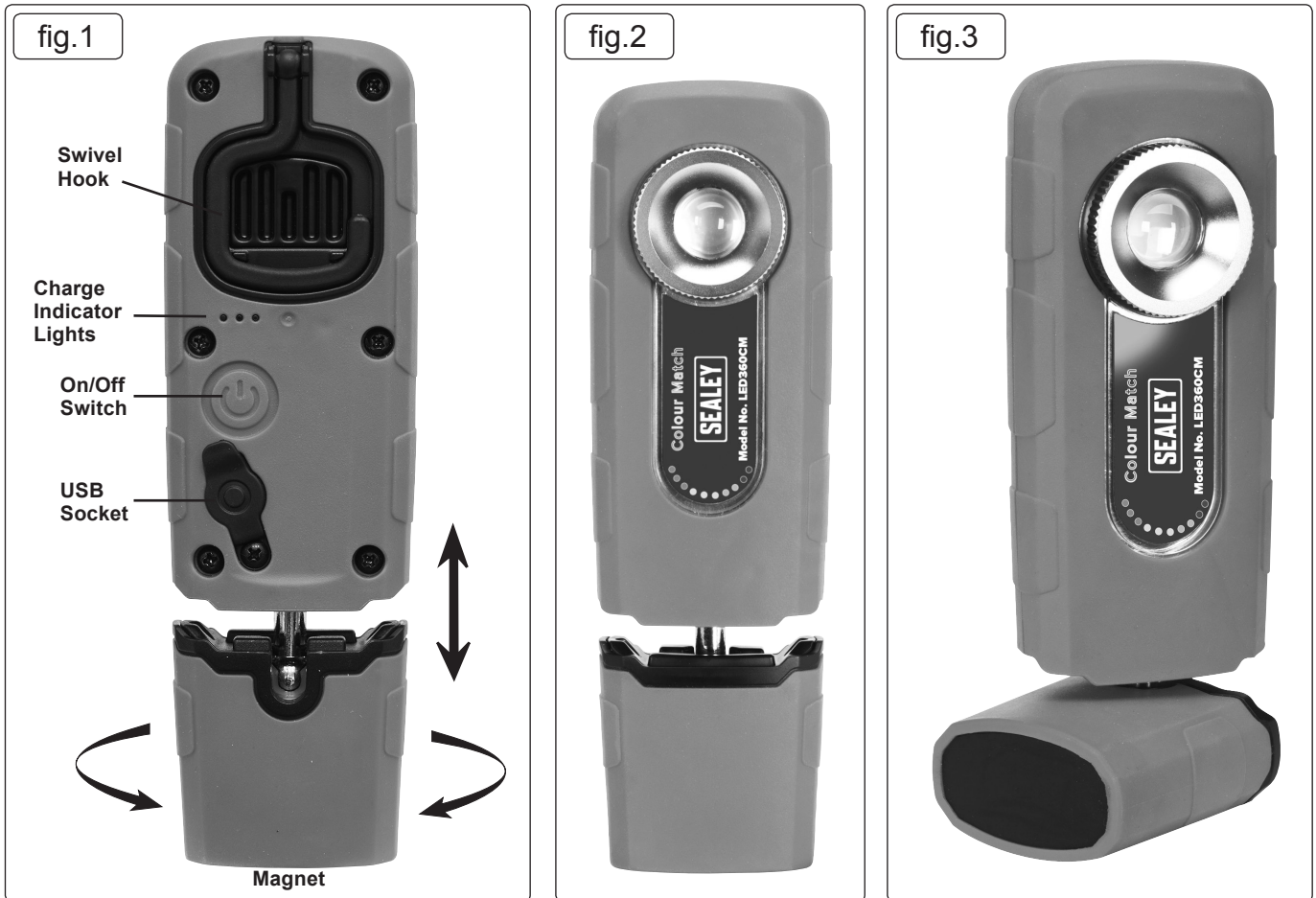

Parts support is available for this product. Please log on to www.sealey.co.uk, email sales@sealey.co.uk or telephone 01284 757500



ENVIRONMENT PROTECTION

Recycle unwanted materials instead of disposing of them as waste. All tools, accessories and packaging should be sorted, taken to a recycling centre and disposed of in a manner which is compatible with the environment. When the product becomes completely unserviceable and requires disposal, drain any fluids (if applicable) into approved containers and dispose of the product and fluids according to local regulations.



WEEE REGULATIONS

Dispose of this product at the end of its working life in compliance with the EU Directive on Waste Electrical and Electronic Equipment (WEEE). When the product is no longer required, it must be disposed of in an environmentally protective way. Contact your local solid waste authority for recycling information.



BATTERY REMOVAL

Under the Waste Batteries and Accumulators Regulations 2009, Jack Sealey Ltd are required to inform potential purchasers of products containing batteries (as defined within these regulations), that they are registered with Valpak's registered compliance scheme. Jack Sealey Ltd's Batteries Producer Registration Number (BPRN) is BPRN00705.

Note: It is our policy to continually improve products and as such we reserve the right to alter data, specifications and component parts without prior notice.

Important: No Liability is accepted for incorrect use of this product.

Warranty: Guarantee is 12 months from purchase date, proof of which is required for any claim.

Sealey Group, Kempson Way, Suffolk Business Park, Bury St Edmunds, Suffolk. IP32 7AR



01284 757500



01284 703534



sales@sealey.co.uk



www.sealey.co.uk